



16 Collins Close, Wilton, Salisbury, Wiltshire, SP2 0FP

Guide Price £375,000 Freehold

An immaculate semi-detached family home with views over fields to front and green area.

Directions

From Salisbury proceed to Wilton along the A36. In Wilton turn right at the roundabout into The Avenue, proceed over the mini-roundabout and take the first right into Oakley Road. Turn right and take the second left into Collins Close. The road bears round to the right where No. 16 will be seen on the right hand side.

Description

Built in 2016 with brick elevations under a tiled roof, a very well appointed, well insulated modern family home in immaculate order throughout. The property has a particularly high specification and the vendors have carried out a range of improvements to include bi-fold doors to the garden, Amtico flooring to the ground floor, built-in wardrobes and upgraded sanitary ware. The accommodation consists of entrance hall, cloakroom, kitchen/dining room, sitting room, four bedrooms, bathroom and en-suite shower room. There is a private garden to the rear with large patio and driveway parking to the front for two vehicles. Further benefits include gas central heating and double glazing throughout. The house is still covered by the remainder of the NHBC guarantee. The property is situated on the highly regarded Wilton Hill development, a short walk from the centre of Wilton where there are a good range of amenities including shops, doctor's surgeries, coffee shops and Co-op supermarket. The city of Salisbury is approximately 4 miles away and there are good bus services to the city.

Property Specifics

The accommodation is arranged as follows, all measurements being approximate:

Entrance hall

Deep storage cupboard, stairs to first floor, Amtico flooring. Laundry cupboard with plumbing and extractor fan for washing machine and tumble dryer, silestone worktop.

Cloakroom

Low level WC and wash-hand basin with tiled splashback.

Kitchen/breakfast room 15'7" x 8'2" (4.75m x 2.5m)

Silestone splashbacks and worktops with base and wall mounted cupboards and drawers, inset AEG induction hob with hood over, twin bowl sink unit with filter tap and waste disposal, built-in double oven, built-in dishwasher, ceiling downlighters. Amtico flooring.

Sitting room 15'2" x 11'4" (4.64m x 3.47m)

Bi-fold doors to garden.

First floor - landing

Cupboard housing hot water cylinder with shelving. Stairs to second floor with built-in cupboard in stairwell.

Bedroom two 15'5" x 8'6" (4.7m x 2.6m)

Range of mirror-fronted built-in wardrobes.

Bedroom three 11'1" x 8'5" (3.4m x 2.58m)

Range of built-in wardrobes. USB sockets.

Bedroom four 10'2" x 6'6" (3.1m x 2m)

Bathroom

White suite of panelled bath with thermostatic mixer shower over, low level WC and wash-hand basin. Mainly tiled walls. Folding glass shower screen, extractor fan, ceiling downlighters, shaver socket, heated towel rail. Amtico flooring.

Second floor - bedroom one 20'0" x 10'3" (6.1m x 3.13m)

Range of built-in wardrobes, lovely views to front over the green and open fields. Hatch to fully insulated, partially boarded loft space. Door to:

En-suite shower room

Tiled shower cubicle with folding glass screens and thermostatic shower, low level WC and wash-hand basin. Part tiled walls, heated towel rail, extractor fan, ceiling downlighters, Amtico flooring. Boiler cupboard with built-in shelving.

Outside

To the front of the property there are two parking spaces with paved path to the front door and side alley leading to the rear garden. The rear garden has a large paved patio adjacent to lawn with flowerbeds. Water tap and power socket. Garden shed with power. Enclosed by timber fencing.

Services

Mains gas, water, electricity and drainage are connected to the property. There are ethernet ports in most rooms, leading to an ethernet switch in understairs cupboard.

Outgoings

The Council Tax Band is 'D' and the payment for the year 2021/2022 payable to Wiltshire Council is £2,053.73.

Ground Floor
Approx. 38.3 sq. metres (412.1 sq. feet)

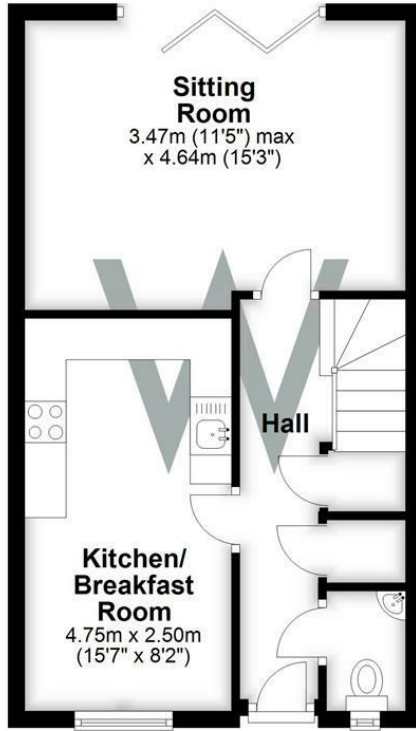
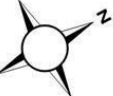

First Floor
Approx. 38.4 sq. metres (413.7 sq. feet)

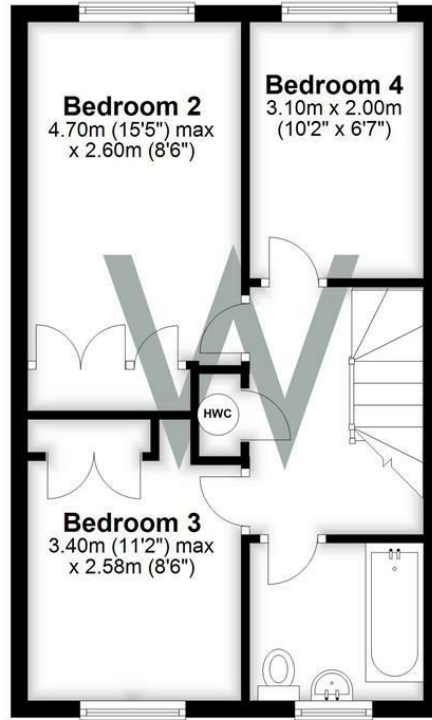

Second Floor
Approx. 25.4 sq. metres (273.6 sq. feet)



Energy Efficiency Rating		Current	Potential
Very energy efficient - lower running costs			
(92 plus)	A	84	93
(81-91)	B		
(69-80)	C		
(55-68)	D		
(39-54)	E		
(21-38)	F		
(1-20)	G		
Not energy efficient - higher running costs			
England & Wales		EU Directive 2002/91/EC	

Total area: approx. 102.1 sq. metres (1099.4 sq. feet)

WHITES
Castle Chambers, 47 Castle Street,
Salisbury, Wiltshire, SP1 3SP
01722 336422
www.hwwhite.co.uk
residential-sales@hwwhite.co.uk



